

PNEUMATIC & REMOTE OPERATION CATTLE HANDLING SOLUTIONS

Proudly Australian designed and manufactured.
Professionally installed across Australia and around the world.



Delivering industry leading solutions that improve livestock handling
EFFICIENCY | SAFETY | PROFITABILITY

EFFICIENCY, SAFETY AND PROFITABILITY ADVANTAGES



PROFESSIONAL RESULTS

ProWay Livestock Equipment's design experience, technical knowledge and innovative product range improves the efficiency, safety and profitability of your operation.

Tailored to suit varied scale livestock operations, all ProWay facilities are built to provide:

- Safer working conditions and less labour required to handle stock efficiently.
- Improved and increased throughput of livestock.
- Timely husbandry due to increased efficiency and ease of operation.
- Systemised weighing, treating and drafting of stock for effective management and processing for specific markets.
- Improved animal welfare with less stress, reduced yarding time and minimal bruising on stock.

REDUCED LABOUR WITH INCREASED WORKPLACE HEALTH AND SAFETY

ProWay's StockFlow™ pneumatic and remote solutions improve labour efficiency by minimising the staff requirement to process stock and reduces the WH&S hazards associated with cattle husbandry operations.

This allows you and your staff to work comfortably, reduces stress, improves safety and increases throughput, ultimately maximising productivity.

All ProWay products are designed and built to handle testing environments and frequent use, with industrial grade components and quality fabrication built to last.

We work with you to ensure your facility is designed for your needs. ProWay facilities are individually designed to operation-specific requirements.

INDUSTRIAL GRADE WIRELESS TECHNOLOGY

ProWay supports Australian innovation and technology throughout the StockFlow™ remote pneumatic range.

From our pneumatic cylinders through to remotes and control boxes, ProWay pneumatic equipment is sourced from reputable Australian suppliers and manufacturers.

ProWay's in-house engineering team, work with leading Australian suppliers and technicians to deliver superior standard equipment, best suited to the livestock industry. Our remote systems offer:

- Comfortable and durable hand-held remotes with an operating range of up to 150 metres.
- Multi channel operation allowing 1-16 functions per remote control, depending on your unique facilities.
- Simultaneous channel transmission meaning multiple remotes or buttons can function at a time.



WHY INVEST IN PROWAY PNEUMATIC FACILITIES?



- Reduced labour input
- Timely husbandry operations
- Increased safety for livestock and operator
- Automated and remote control
- Stress free handling
- Minimised bruising
- Weighing and drafting accuracy
- Premium materials and components
- After sales service supported by Australian engineers, technicians and suppliers

Joseph Kerin | Livestock Manager
Kerin Agriculture, Yeoval

Scan for video and story



Find these yards on:

"We put a lot of thought into this pneumatic system and worked out that with the efficiency gains, it was only a matter of a few years before the yards had actually paid for themselves".

Nigel Kerin
 Kerin Agriculture | Yeoval, NSW

With an emphasis on efficiency and ease of operation, the Kerin's cattle yards are fully autonomous.

This means cattle can be worked by a single operator, increasing productivity to ultimately get stock back on pasture in a timely manner.

Each ProWay StockFlow™ system is designed to run on a single air supply which our specialist team can advise on depending on your requirements.

The remote control is synced with a central base station which transmits a signal through control cables to each pneumatic product.

Open and shut functions are instant at the press of a button.



When designing and building livestock handling facilities, ProWay's focus is on:

Maximising stock-flow

ProWay specialise in designing products and facilities that utilise natural stock behaviour, reducing stress on you, your employees and your stock.

Suitability of materials

No two operations are the same. Our experienced designers are committed to providing solutions based on your specific site and requirements.

Operator efficiency and safety

Our products are second to none in terms of workplace productivity. This is proven by our repeat customers and commitment to continued innovation.

Product longevity

We're committed to providing high quality Australian designed and manufactured equipment that we proudly stand behind.

ProWay stockyards and stock handling equipment has earned the reputation of being "cutting edge" in terms of operator safety and stock flow.

This is why we have many repeat clients and it is why serious, progressive livestock producers across Australia and the world choose ProWay to design and build their stockyards.

We work closely with primary producers and industry stakeholders during the design process and throughout the life of the facility, to improve efficiency, safety and profitability across the livestock industry.

INDUSTRY LEADING DESIGN, INNOVATION AND SERVICE

The advantages of working with ProWay are our experience in stockyard design, industry expertise and our innovative products to deliver turnkey solutions.

Our focus on providing equipment that promotes safety and stock-flow is backed by our customers and livestock professionals across Australia and the world.

It is this experience and valued customer feedback that has led us to our refined products and service.

Our pneumatic technicians and engineers custom build and install specialty livestock handling facilities on a weekly basis.

We work closely with industry leading indicator suppliers and component manufactures to deliver the best outcomes for our clients.

ProWay's knowledge and adaptability to new technology means you are getting the latest in livestock innovation as well as a long term partnership well after your yards are completed.



ProWay focus on individual operations and customise a solution tailored to each site.

We use the highest quality components, built for harsh environments. Like any moving parts and machinery, wear on equipment is par for the course, depending on a number of factors and frequency of use.

The benefit of working with an experienced, Australian manufacturer is that our after sales support, expertise and replacement components are local, should you require assistance in the future.

“ Our labour efficiency has more than doubled compared to the old yards. The air operated aspect would save a man in itself. Just a press of a button, we weighed and drafted 320 heifers with RFID in under an hour. ”

Peter Gordon | Livestock Manager
GAIT Co. Minjah Farm, VIC



Find these yards on:

Scan for video and story

Every ProWay StockFlow™ pneumatic facility receives a project manual outlining button designation, unique pneumatic function descriptions, maintenance schedule and full electrical schematics.

ProWay keep a record of your unique parts list and fit-out. In the event you require assistance, we can offer trouble shooting and/or deliver replacement components in a timely fashion.

We work with your existing infrastructure and equipment and understand that technology is constantly evolving in livestock data management.

ProWay have excellent technical relationships with leading indicator suppliers, programmers and data management systems to ensure our products are compatible with yours, now and into the future.

PROFESSIONAL REMOTE SOLUTIONS

The below example design includes numerous StockFlow™ pneumatic features. These allow the operator to control cattle flow through the working area and draft with a hand-held remote control.

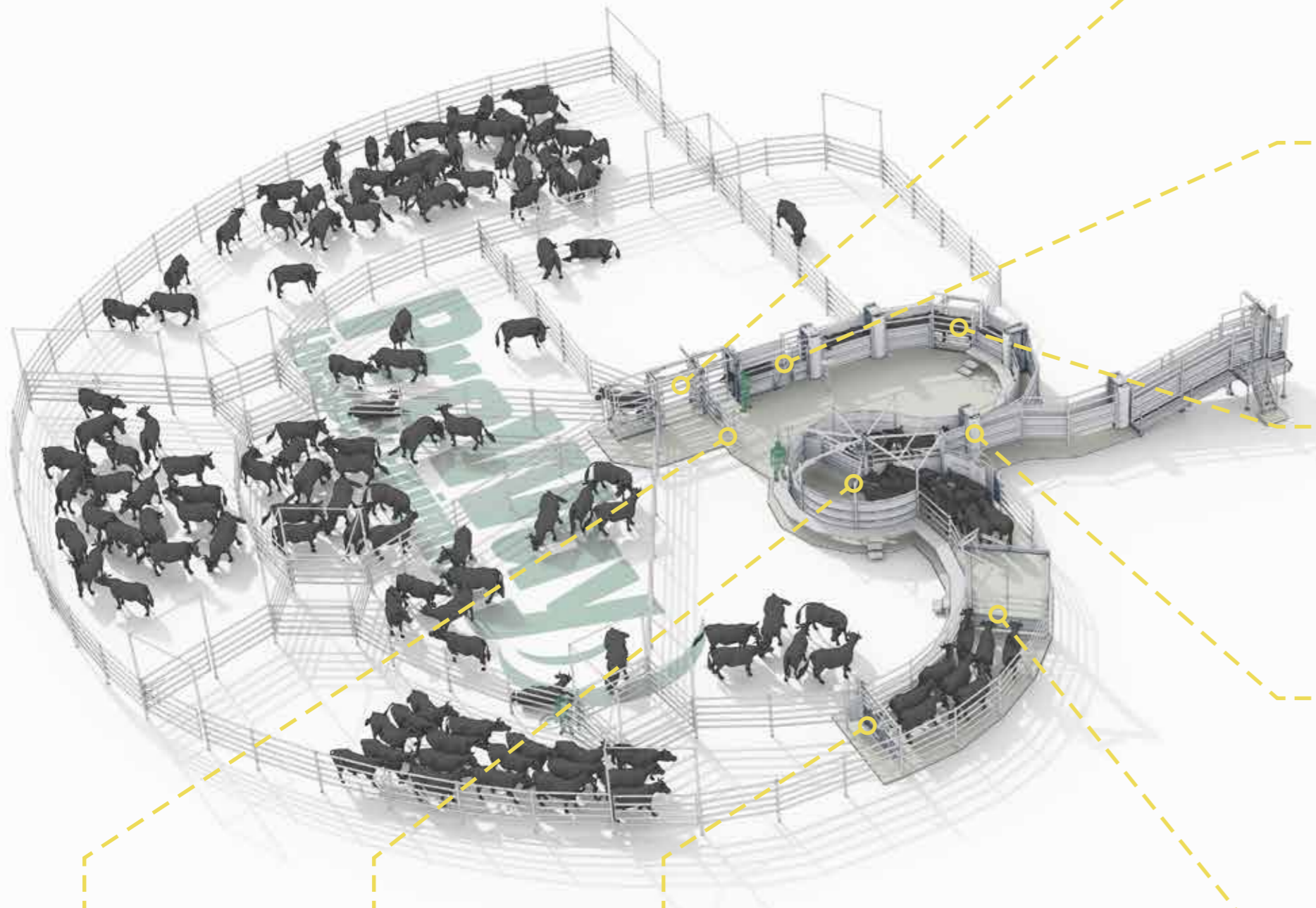

5 Way Pneumatic Draft

ProWay offer 3, 5 and 7 way draft units which open at the press of a button. Alternatively the unit can be supplied fully automated, drafting based on cattle weights and/or scanned EID tags.

Pneumatic Crush

ProWay can fit-out your cattle crush and head-bale to open and shut remotely or offer a weigh-box unit that is fit with a rotary block gate entry and heavy duty pneumatic headbale at the exit.

Pneumatic Race Draft

Installed within the race to allow drafting before the crush. This allows the operator to draft mid race. Manufactured to suit the radial arc of the race, for straight or curved designs.

Rotary Block Gate

Developed for single file working races, ProWay Rotary Block Gates pivot in two directions to safely and efficiently block off or open the race to the crush and draft.

Pneumatic Guillotine Gate

The gate lifts vertically which leaves an opening for cattle to walk under. At the press of a button, the gate lowers to return to its ground position.

Pneumatic Control Box

At the centre of the facility is the multi-channel receiver, which relays the remote signal to individual products. Secured in an industrial grade electrical cabinet and custom built specific to the operation.

Pneumatic Rotary Force

The most efficient cattle force available for continuous stock flow into the race. ProWay's "Tick Tock" rotary force has two remote operated gates which pivot a full 360°.

Pneumatic Swing Gate

Remote operated gate that swings open with the press of a button. This style gate is ideal for lead-up yards to the force. The bolt catch releases and engages as it opens and shuts.

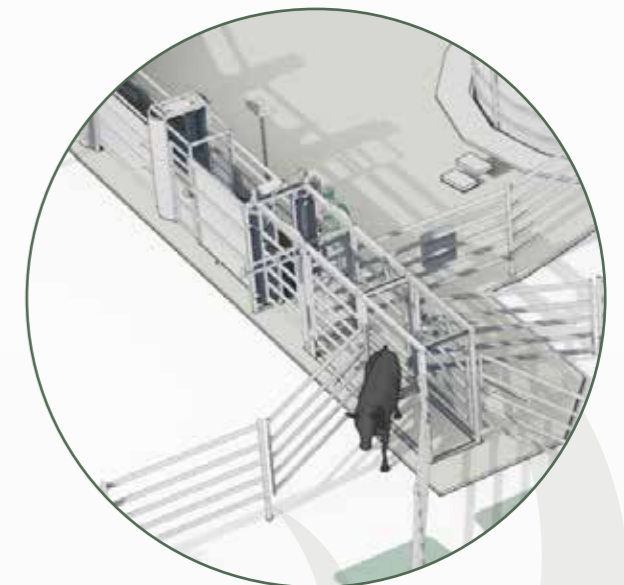
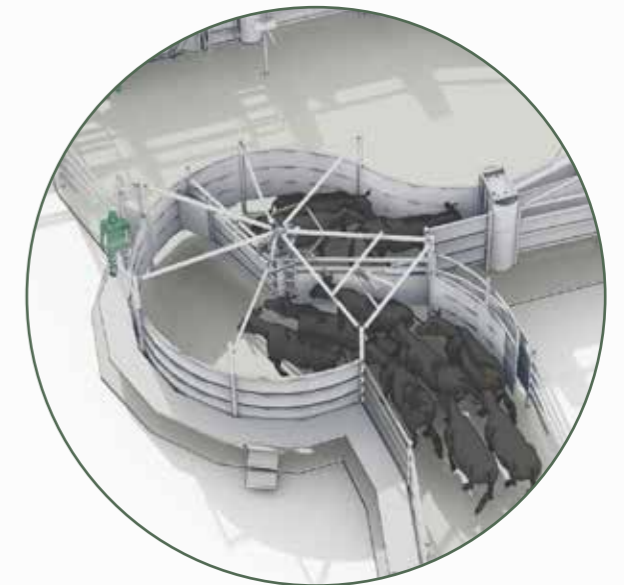
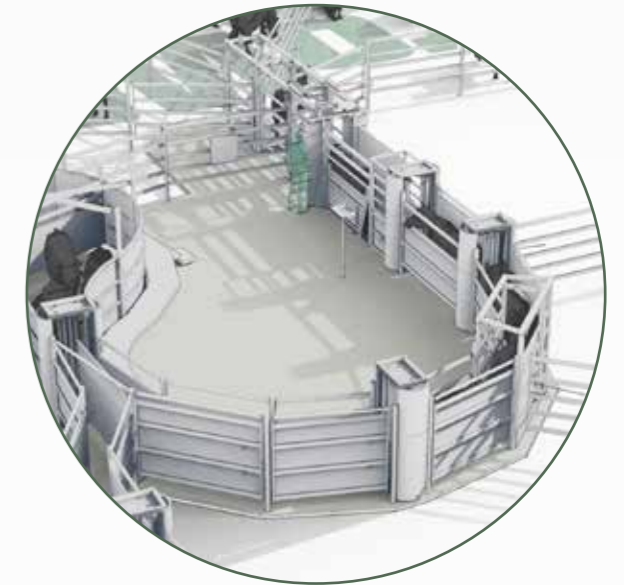



Being Australian made, we knew we would get good ongoing local support.

The benefits of the new yards are outstanding, we are really happy with the final result.

Matt Vaughan | Property Owner
LarnOO Pastoral, Ghin Ghin VIC

Scan for video and story



Find these yards on: 



PNEUMATIC CONTROLS:

PNEUMATICS | EFFICIENCY, SAFETY & PROFITABILITY ADVANTAGES

INDUSTRIAL GRADE REMOTE



ProWay pneumatic equipment is primarily controlled with a hand-held remote that is programmed specifically to your operation.

- Remotes can cater from 2 up to 16 operations on a single control.
- The transmitter uses "frequency hopping" to allow multiple transmitters to be used in close proximity with no interference or jamming.
- Runs on a supplied 9V battery and is synced to the control box.
- Comfortable to hold and durable with an operating range of up to 150 metres.
- Relatively inexpensive, Australian supplied and can be replaced or duplicated easily.

STATIONARY CONTROL POINTS

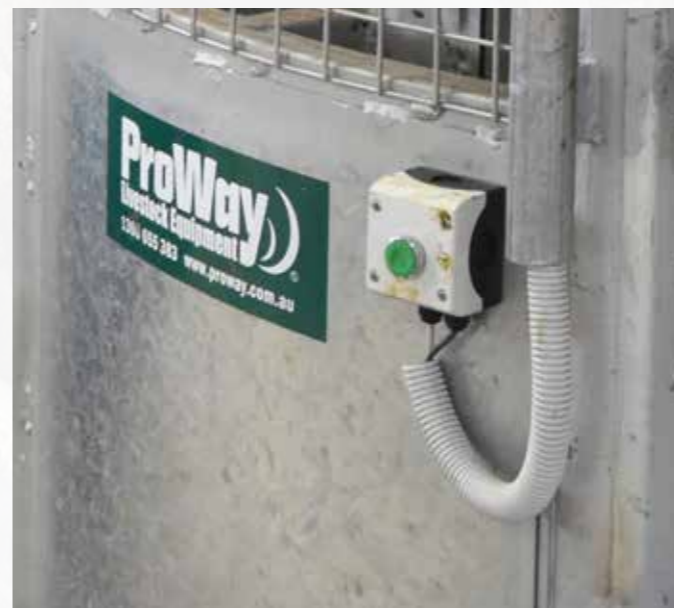

For some products such as Rotary Block Gates, fixed control points can be installed allowing operation at the gate.

- Not all staff carry remotes so it's worth considering fixed control points on race gates.
- These are industrial grade single button fixtures mounted at a convenient height.
- No batteries required as the switch is wired directly to the control box.
- Offers a fail safe control should the remote get damaged, lost or go flat.
- Pressing the button will alternate between open and close function.

CENTRAL CONTROL BOX



At the heart of the pneumatic facility, the "control box" or "base station" relays signals to the air valves and cylinders.

- Custom built by ProWay engineers, specific to your job and the pneumatic products included in your facility.
- Can be customised should you wish for certain buttons/numbers to determine specific functions. Eg:
- Button (1 - 3) main and secondary draft options
- Button (4 - 8) Head-bale and Race gates
- Supplied in a premium grade electrical cabinet.
- All wiring, switches, air regulators and installation included.



PNEUMATIC DRAFTING OPTIONS:



REMOTE OR AUTO DRAFTER

Premium grade, single file drafting solution, developed to dramatically reduce labour when drafting through the crush.

- Available in 3, 5 and 7 way draft.
- Can be upgraded to include a split gate in front to provide a further draft option (4, 6, 8 ways).
- Built with oval rail for strength, hot dipped channel base and industrial grade pneumatic cylinders and fittings for longevity.
- Rubber stoppers for quiet open/close operation.
- Auto-draft upgrade includes a control box that integrates with industry leading indicators and will draft on weight or individual cattle traits.



IN LINE RACE DRAFT

The pneumatic in line race draft can be installed within a section of the working race to allow drafting before the crush.

- Gives a further draft option and makes splitting single animals out of the race easier and quicker.
- Hand-held remote for flexibility allowing the operator to draft from anywhere in the yards.
- Sheeted outside and cattle rail inside to encourage stock flow.
- Heavy duty galvanised frame, channel base and industrial pneumatics for longevity.
- Manufactured to suit radial arc of the race and built for your individual straight or curved race design.



POUND DRAFT

A remote alternative to a traditional pound draft which allows safe and streamlined drafting leading up to the force.

- Designed for large scale, high throughput operations offering efficient and safe drafting flexibility in multiple directions.
- Best utilised in a central location of the yards with access to multiple pens.
- Each gate operates on an individual pneumatic cylinder and is braced overhead for strength and mounting airlines.
- Gates close against rubber stops and a bolt catch locks the gate shut.
- Operated from a crows nest (raised platform) suspended above the pound.



The efficiency gains of the pneumatics are one of the key advantages of these yards.

The cattle just move through the force and draft without stress.

Jono Ashby | Livestock Manager
Thomas Food International Tintinara, SA

Scan for video and story



Find these yards on:





PNEUMATIC GATE OPTIONS:



REMOTE "SWEEP" ROTARY FORCE

Designed to increase efficiency and safety over a conventional rotary force by removing the need to work in close proximity of the force.

- Allows open and close gate function without the need to physically push or pull the gate around.
- Operates with the press of a button and controlled from anywhere in the yards.
- Low stress as the operator can be positioned out of sight, minimising baulking.
- The automated locking system engages when the gate is closing and releases when opening back up.
- Fully sheeted with heavy-duty materials and components.



REMOTE "TICK-TOCK" ROTARY FORCE

The most efficient cattle force available for continuous stock flow into the race.

- ProWay's "Tick Tock" rotary force has two remote operated gates which pivot a full 360°.
- As the first mob enters the race, a secondary gate is engaged to pick up the next lot of cattle to be brought around, ensuring constant, uninterrupted stock flow.
- Cattle naturally follow the curved pen and can be ushered around into single file with the remote controlled gate locking in behind them.
- Dual pivoting internal gate system, overhead bracing and race lead-up panels made from premium quality materials and components.



ROTARY BLOCK GATE

The most effective and safe cattle race gate on the market, featuring dual pivoting to open and shut off the working race.

- The gates pivot on a central axis from open to closed in one motion.
- The two pivoting gates feature individual roll bars in the centre, minimising bruising to cattle.
- Moving parts are confined inside the unit with no moving protrusions into the working area, keeping operators safe.
- Industrial grade pneumatic cylinder for longevity.
- Can be operated from anywhere in the yards which avoids spooking cattle, that can happen with conventional sliding gates.



PNEUMATIC UPGRADES:

PNEUMATICS | EFFICIENCY, SAFETY & PROFITABILITY ADVANTAGES



PNEUMATIC WEIGH-BOX CRUSH

Designed for efficient and accurate individual walk over weight data capture. ProWay's weigh-box is industry leading for strength and quality.

- Pneumatic rotary block gate entry and remote operated headbale at the exit for continuous flow of cattle without levers or manual labour.
- Vet access doors on the working side allow quick access for husbandry practices.
- Wooden mounting frame for panel readers on the outside to eliminate interference.
- Galvanised construction with our trademark quality and fit for purpose design for longevity.
- Designed to suit a variety of load cells and indicators (not included but can be supplied).



PNEUMATIC GUILLOTINE GATE

This remote operated gate lifts vertically leaving a through-way for cattle to walk under.

- Ideal for high throughput between pens or in a lane-way system lead-up such as an abattoir.
- Overhead lifting arms are designed to reduce the height of the unit
- Hinged mechanism for lifting and lowering so it descends freely and prevents cattle being injured as it closes.
- Opens and returns to ground position at the press of a button.
- Can be adapted to a pound draft system for multiple direction drafting.



PNEUMATIC SWING GATE

A single remote operation gate which can be installed and operated from anywhere in the yards.

- Ideal for wide throughput openings with a gate width range of 2 – 3 meters.
- Gate swings in one direction to a fixed post and back again.
- Braced overhead with heavy-duty galvanised construction and a pin and cone hinge system.
- Industrial grade pneumatic cylinder for longevity.
- Bolt catch opens and engages with the latch pocket as part of the open and shut sequence.



FEATURE DESIGN:

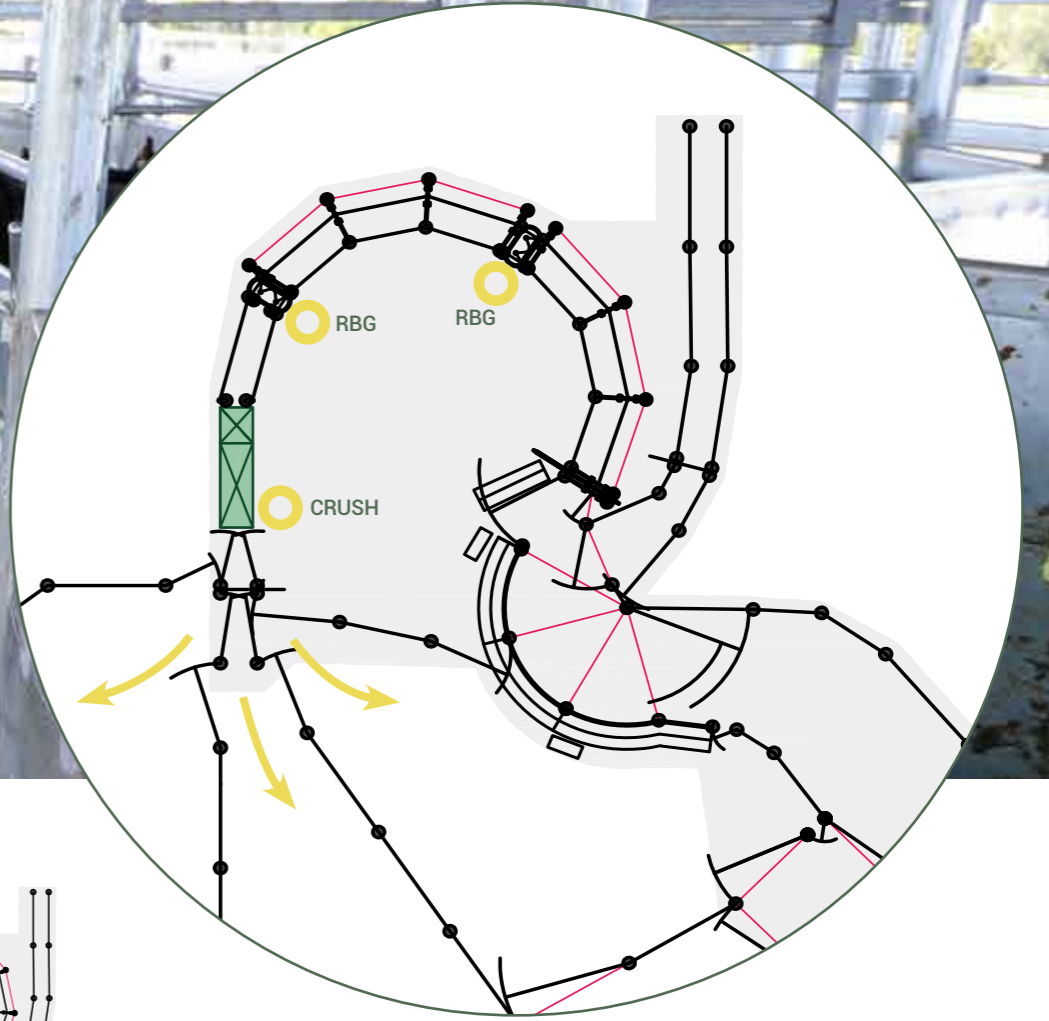

"Argyle" | Willaura, VIC

WORKING CAPACITY: 380 HD

For property owner David Laidlaw and manager Chris Robinson, incorporating pneumatic technology facilitated a significant reduction in labour when processing cattle through the race.



The pneumatics alone save a hell of a lot of time. It's become a one-person operation and it's as simple as pressing a button.

Everything is so much quicker, we've at least halved our time.

Chris Robinson | Farm Manager
Willaura VIC

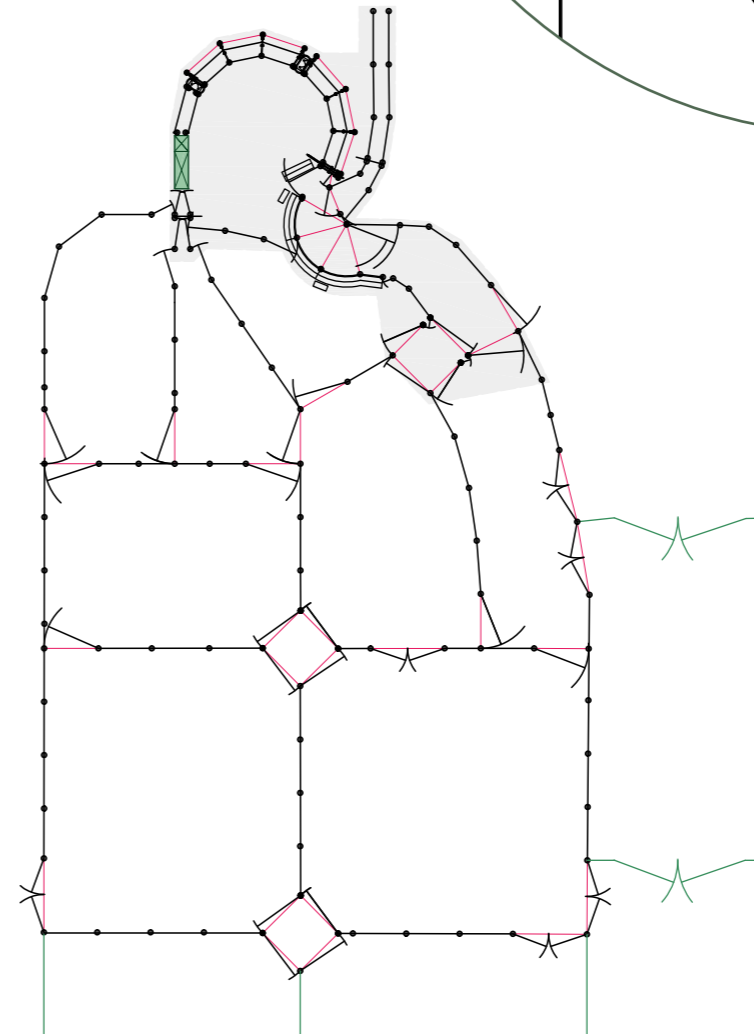

DESIGN FEATURES:

CONTROL POINTS:

- 3 WAY DRAFT
- HEADBALE (HB)
- ROTARY BLOCK GATES (RBG)

YARD FEATURES:

- ADJUSTABLE WIDTH RACE
- ROOF OVER WORKING AREA
- ROTARY FORCE
- WALKWAYS
- 97 CATTLE RAIL

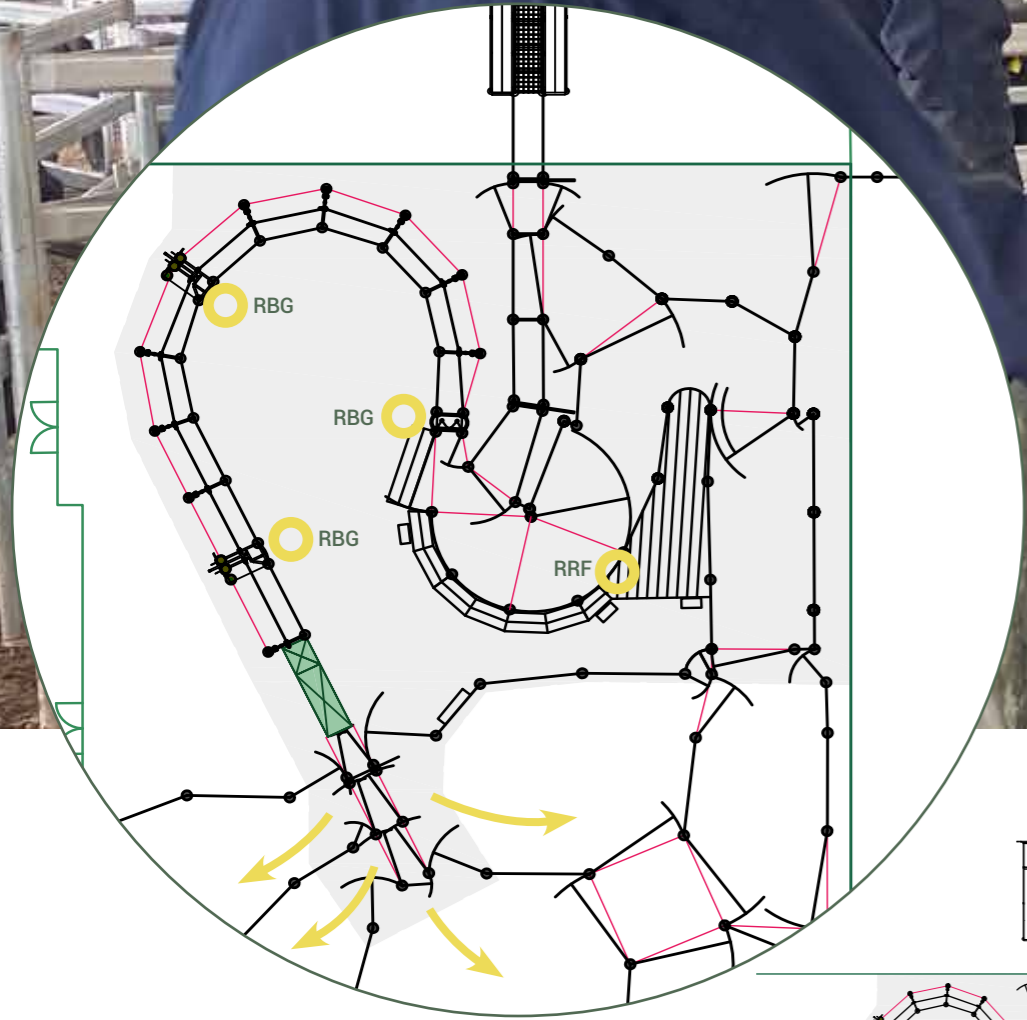

FEATURE DESIGN:

“Larn00” | Ghin Ghin, VIC

WORKING CAPACITY: 450 HD

The cattle free working area incorporates a pneumatic rotary force, adjustable race, raised walkways and air-operated gates to streamline safe cattle processing.



DESIGN FEATURES:

CONTROL POINTS:

- 4 WAY DRAFT
- REMOTE ROTARY FORCE (RRF)
- 3 x ROTARY BLOCK GATES (RBG)

YARD FEATURES:

- ADJUSTABLE WIDTH RACE
- WALKWAYS
- 12.5 DEGREE LOADING RAMP
- BRACED DIAMOND YARDS
- 97 CATTLE RAIL

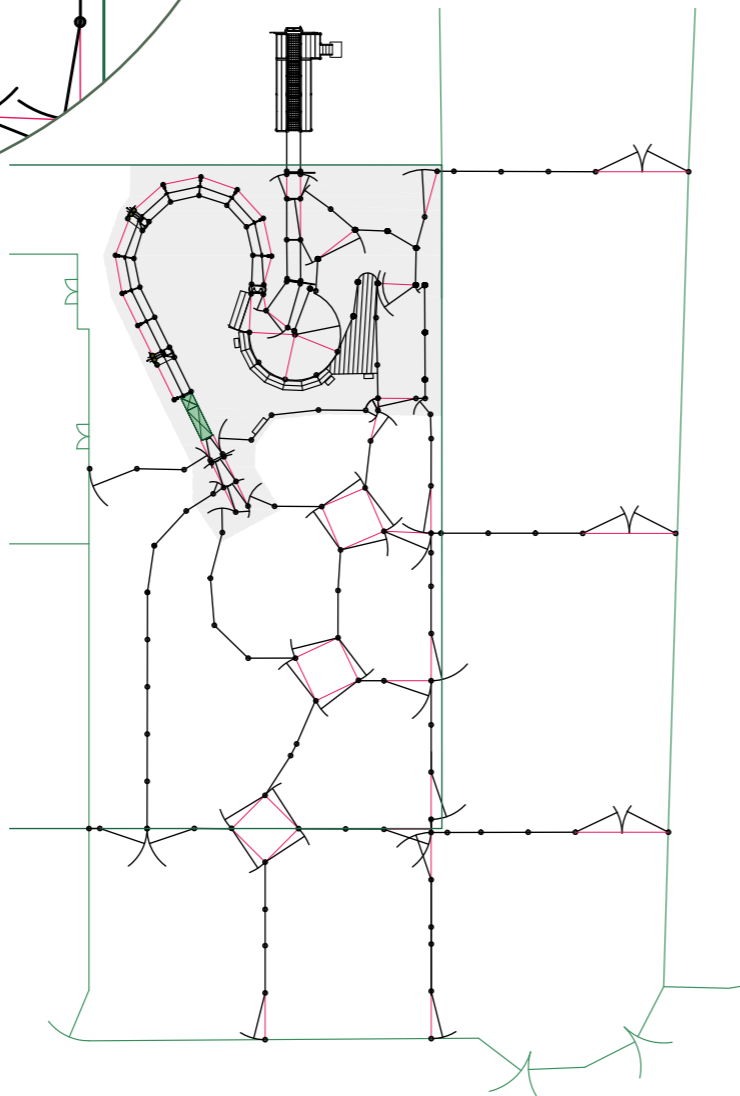

The rotary force is a single button to pull the gate around.

It's simple to operate and means we can fill the race without having to be standing in a fixed location, which is a big benefit.

Jarrod McKay | Farm Manager
Ghin Ghin VIC



FEATURE DESIGN:

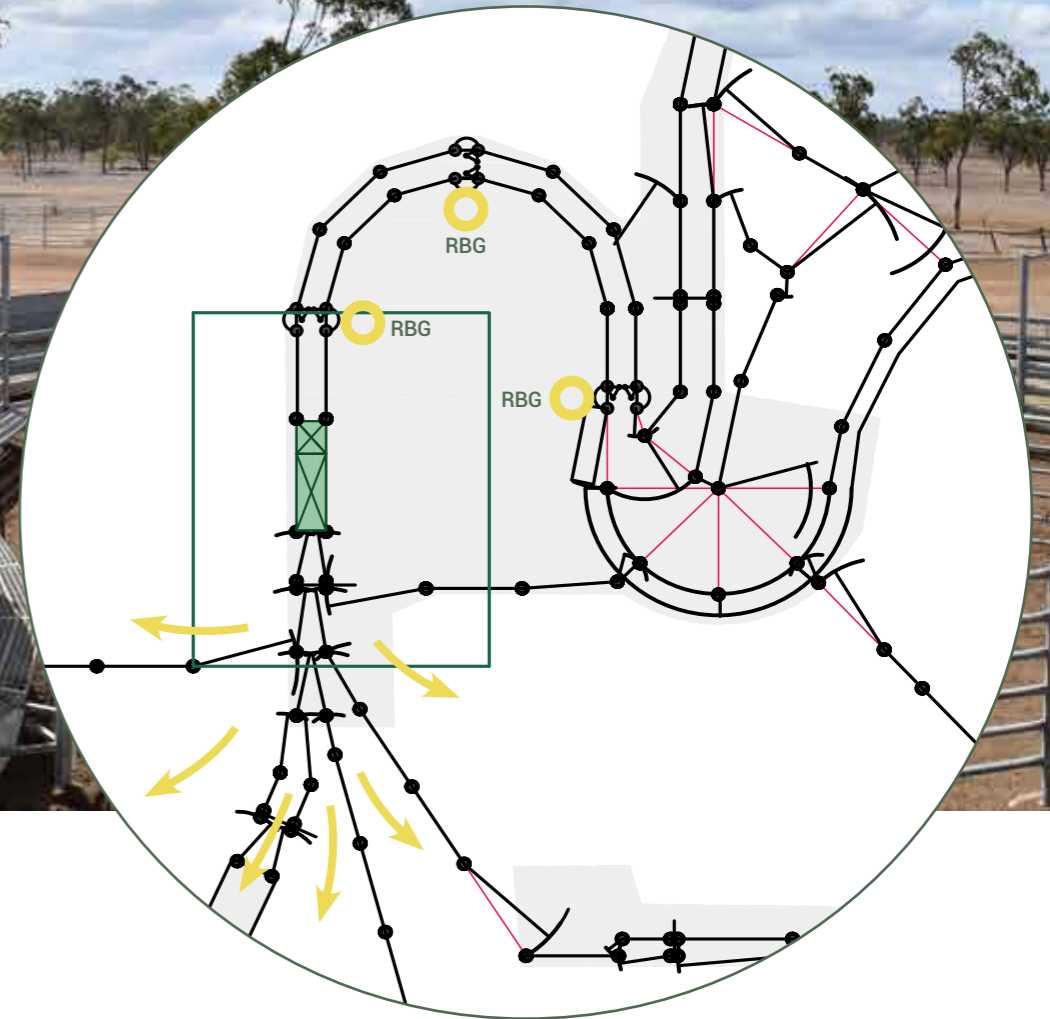

“St Albans Station” | Nebo, QLD

WORKING CAPACITY: 850 HD

The inclusion of an Auto-draft system means mobs can be split based on weight or ear-tags automatically. While the rotary block gates in the race can be operated with a remote or stationary control point.

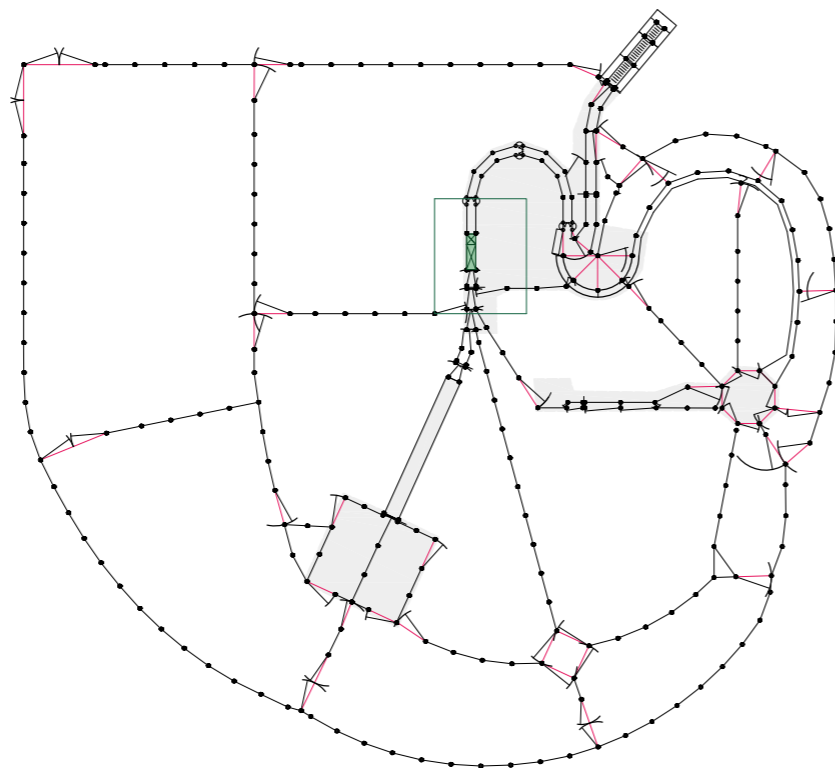

DESIGN FEATURES:

CONTROL POINTS:

- 5 WAY AUTO DRAFTER
- 3 x ROTARY BLOCK GATES (RBG)

YARD FEATURES:

- ROTARY FORCE
- WALKWAYS
- 12.5° QLD SIDE LOADING RAMP
- BRACED DIAMOND YARDS
- POUND YARD
- CALF RACE
- DIVERSION TO PLUNGE DIP
- 120 CATTLE RAIL WORKING AREA
- 50NB PIPE HOLDING YARDS



In terms of our productivity, we can muster and turn out bullocks now in half the time. Air gates and the auto-draft makes it much easier.

We're not having to think which pen to draft into. It just does it automatically.

John Howard | Owner
Nebo QLD



FEATURE DESIGN:

“Southern Cross” | Tintinara, VIC

WORKING CAPACITY: 1,000 HD

Complete pneumatic control in the working area combined with a hydraulically operated crush make this system an extremely labour efficient, safe and flexible workplace.



The stress-free side of these cattle yards is probably one of the key elements. The ability to open and close gates pneumatically makes that whole flow of cattle much more achievable.

Jono Ashby | Farm Manager

Tintinara SA

DESIGN FEATURES:



CONTROL POINTS:

- 5 WAY DRAFT
- REMOTE ROTARY FORCE (RRF)
- 3 x ROTARY BLOCK GATES (RBG)
- IN-RACE DRAFT (RD)

YARD FEATURES:

- SHEETED V-RACE
- UNDER & OVER LOADING RAMP
- UNLOADING DUMP
- POUND YARD
- CALF RACE
- WALKWAYS
- DIAMOND YARDS
- 97 CATTLE RAIL

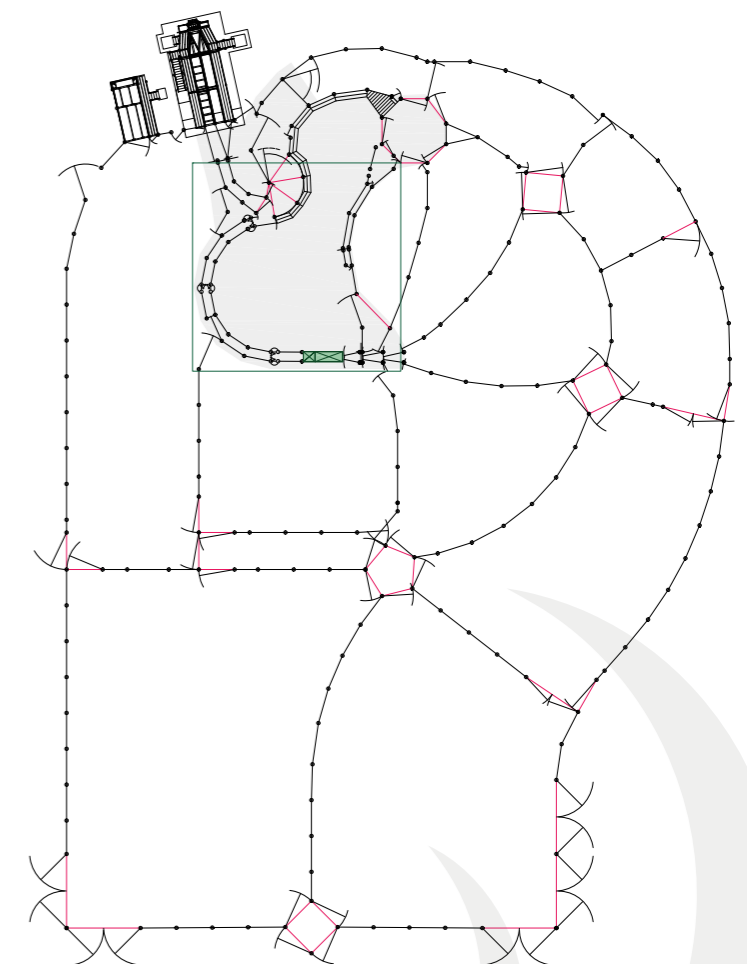
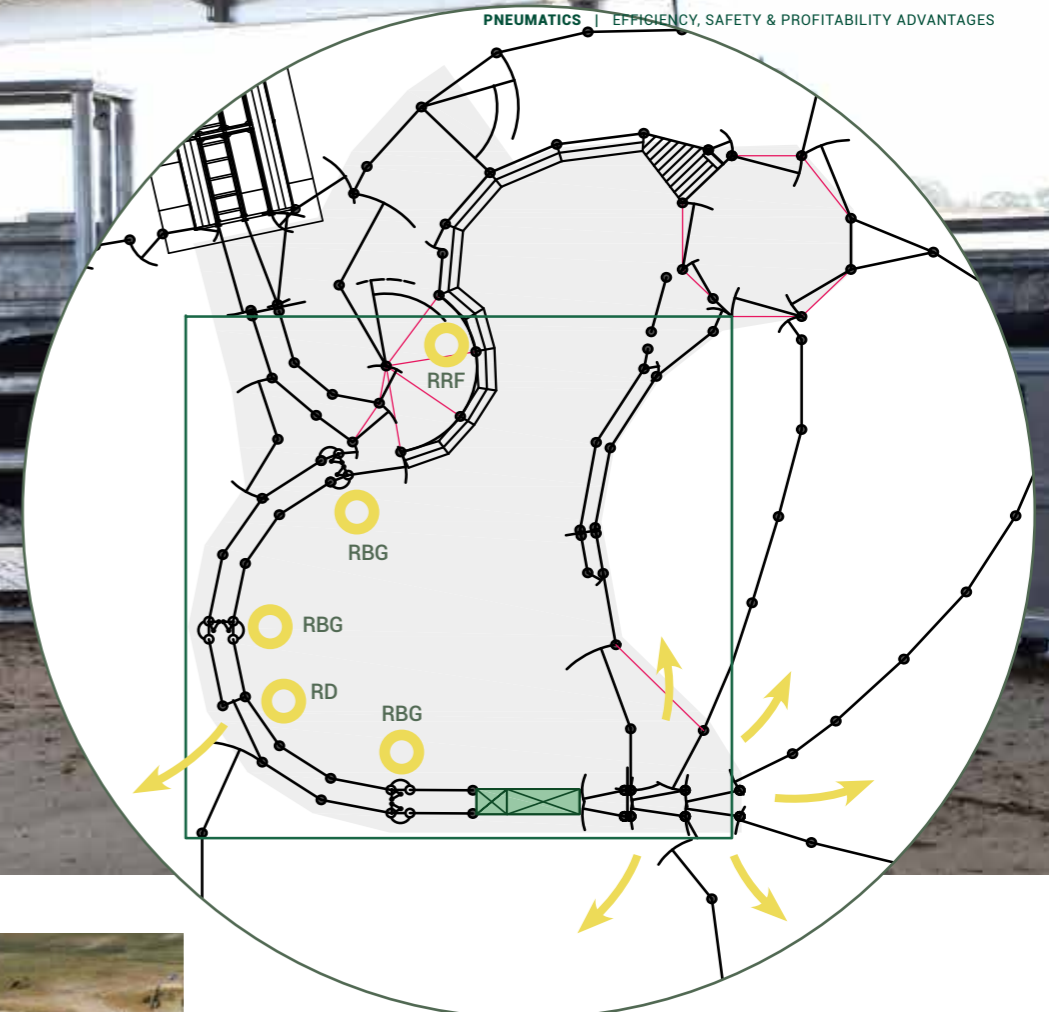

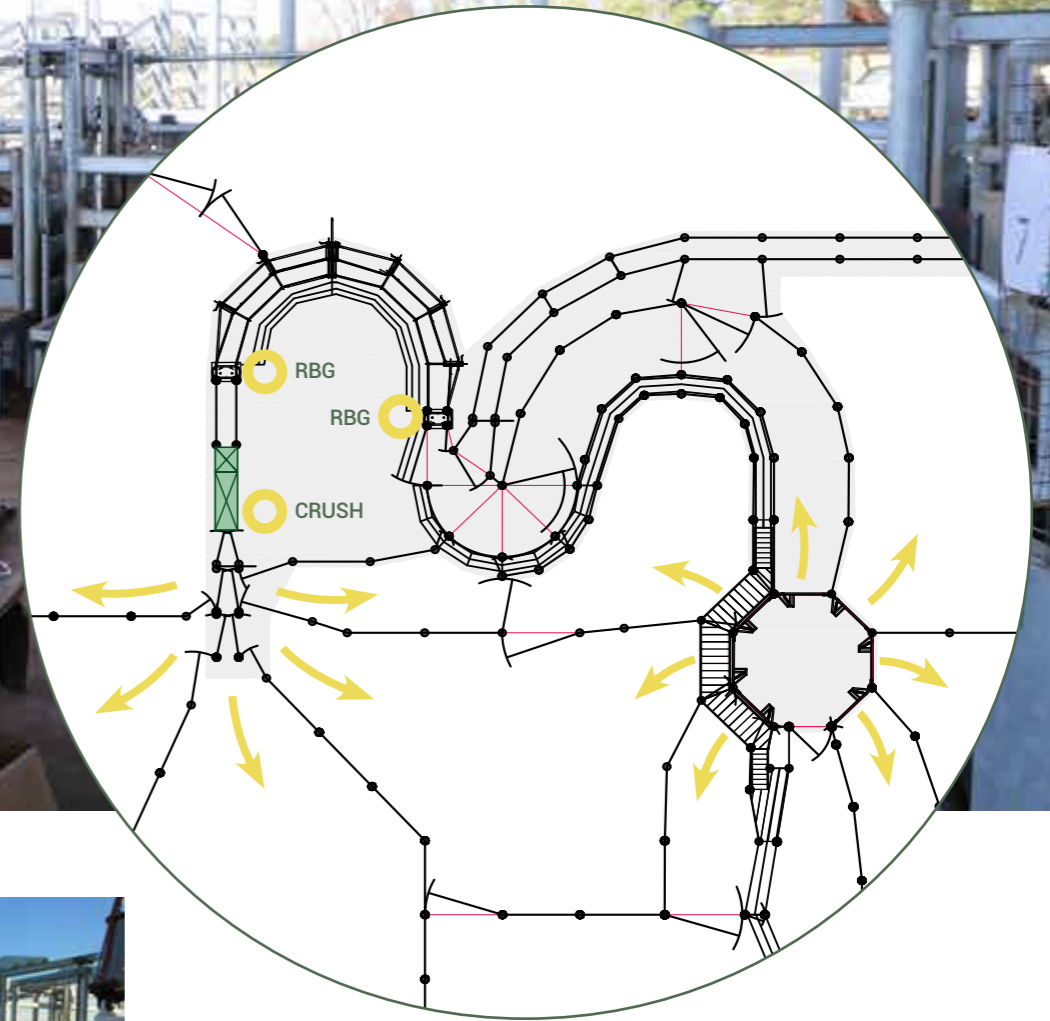

FEATURE DESIGN:

**“Mundabullangana Station”
Port Hedland WA**

WORKING CAPACITY: 3,000 HD

Running a commercial herd of 7,000 droughtmaster cows Co-principal Michael Thompson wanted to achieve a state-of-the-art facility that was capable of processing large numbers as efficiently and safely as possible.

DESIGN FEATURES:

CONTROL POINTS:

- 8 WAY POUND DRAFT
- 5 WAY RACE DRAFT
- 2 x ROTARY BLOCK GATES (RBG)
- PNEUMATIC CRUSH/HEADBALE

YARD FEATURES:

- ADJUSTABLE RACE
- ROTARY FORCE
- WALKWAYS
- 120 CATTLE RAIL

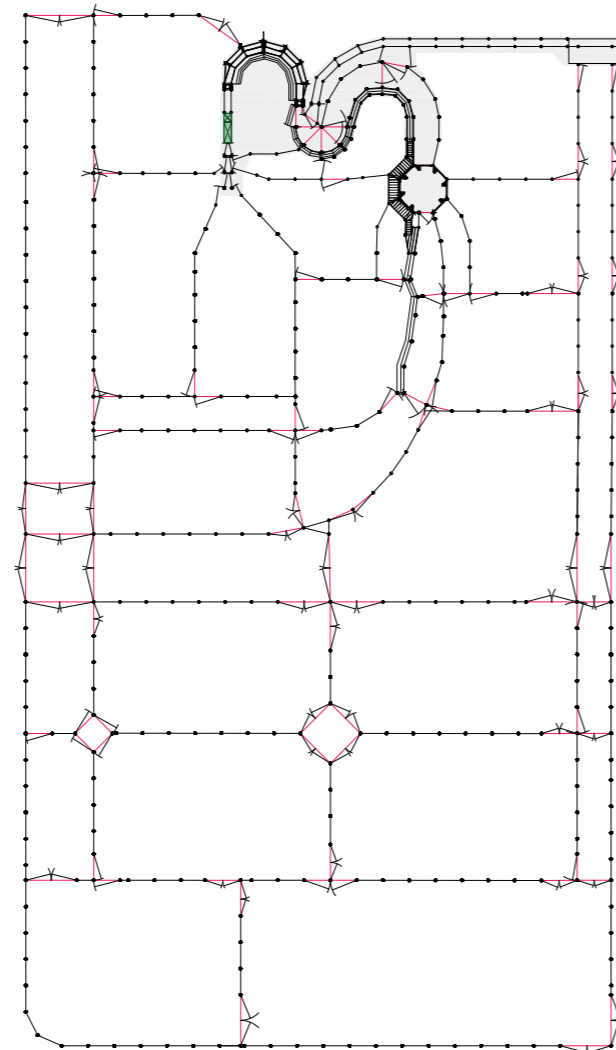

These cattle yards take our business to the next level. They are high quality, safe and easy to work in.

The air gates have resulted in a 100% increase in productivity in the working area.

Michael Thompson | Owner
Port Hedland WA



TRUSTED THROUGHOUT THE INDUSTRY SUPPLY CHAIN

REMOTE SOLUTIONS FOR COMMERCIAL OPERATIONS

SALEYARDS

Millions of livestock are weighed, drafted and sold through ProWay saleyard facilities with the aid of pneumatic technology. Air powered gates make livestock sales more efficient, safe and profitable.

FEEDLOTS AND CORPORATE AGRIBUSINESS

Timely husbandry means livestock are back on feed sooner. We work with professional feedlots and large scale operations to deliver productivity and safety advantages across the business.

ABATTOIRS AND LAIRAGES

ProWay work closely with abattoirs and holding facilities to deliver technology and handling infrastructure which reduces labour and maintains best practice welfare for both livestock and operators.



We wanted to introduce as much technology as possible to make our job easier and allow the facility to work to its capacity.

We want to run the most efficient and animal welfare conscious facility we can and ProWay have done an outstanding job in helping us achieve these goals.

Rod Bourlet | Facility Manager
SELX | Yass, NSW

PROFESSIONAL RESULTS

ProWay has a dedicated team of livestock facility designers specialising in the intricacies of large scale infrastructure.

As well as on farm facilities, our experience in large scale projects provides first-class infrastructure for Saleyards, Abattoirs, Lairages and Feedlots.

We specialise in custom solutions in terms of complete facility “design and construct” or can focus on improvements to key areas such as automated or remote weighing and drafting. ProWay specialise in reducing labour and increasing WH&S compliance with the introduction of technology to your operation.

We use a combination of innovative solutions, industrial grade materials and componentry, and quality design gained through years of experience. As a result, ProWay facilities provide safety, efficiency and profitability gains to your operation for many years to come.

THE CHOICE OF LIVESTOCK PROFESSIONALS

Head Office: 19 Bomen Rd, Bomen NSW

Regionally based designers servicing clients across Australia

Phone: 1300 655 383

Fax: 02 6931 8410

E-mail: information@proway.com.au

ProWay
Livestock Equipment

www.proway.com.au

